



**STREAMLINED DESIGN AND MAXIMUM PERFORMANCE**

- Designed for high rotational speeds, these models react to low operational torque...the perfect swivels for longer ropes and cables.
- Manufactured with two or more flush ground angular contact ball bearings.
- Bearings are permanently lubricated with high-pressure grease and sealed at the factory.
- Flush pins are available for overhead and underground electrical line stringing (please specify). Swivel ends are shaped to prevent snagging when gliding over sheaves and other potential obstructions.
- Heat treated high strength alloy steel, zinc plated for corrosion resistance, provides the strongest yet lightest swivel available. Ultimate strength is minimum 4.5 to 1 over SWL (Safe Working Load).
- All swivels proof-tested and certified.

**6000 SERIES GOLD BAND SWIVELS**

SIZE	SWL TONS	WIRE ROPE SIZE	A	C PIN DIA	D	E	F	G	H	I	J HOLE DIA	K
12	.5 (.9)	1/8	7/8	5/16	5/16	1/4	15/32	7/8	3/8	3/8	1/4	3/8
25	.75 (2)	1/4	1-1/4	3/8	19/32	5/16	11/16	31/32	1/2	7/16	3/8	7/16
37	1.5 (4)	3/8	1-1/2	7/16	19/32	1/2	13/16	1	23/32	9/16	5/8	5/8
50	3 (5)	1/2	1-7/8	5/8	3/4	3/4	15/16	1-11/32	15/16	13/16	7/8	15/16
62	5 (8)	5/8	2-7/16	7/8	1	1	1-9/16	1-11/16	1-5/16	1-1/8	1-1/4	1-3/16
75	8.5 (15)	3/4	2-7/8	1	1-9/32	1-1/4	2-1/8	2-1/4	1-5/8	1-1/4	1-3/8	1-1/2
81	8.5 (15)	3/4	2-7/8	1-1/8	1-9/16	1-1/4	2-1/8	2-1/4	1-5/8	1-1/4	1-3/8	1-1/2
87	10 (17)	7/8	3-5/8	1-1/2	1-3/4	1-23/32	3-1/2	3	2-27/32	1-3/4	1-5/8	1-13/16
99	15 (20)	1	3-5/8	1-1/2	1-3/4	2	3-1/2	3	2-25/32	1-3/4	2	2-1/8
150	35	1-1/2	5-3/8	2	2	2-1/4	3-11/16	3-3/4	3-1/8	2-3/8	2-1/4	2-3/8

ALL DIMENSIONS ARE IN INCHES

Specifications could change without notice.

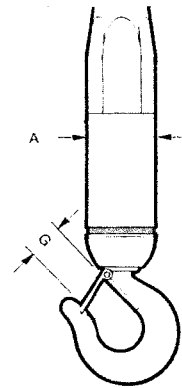

MODEL: 60

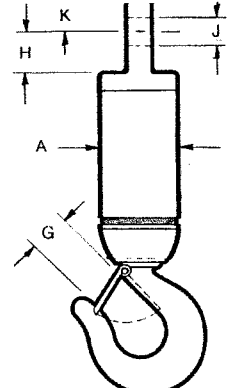

MODEL: 61

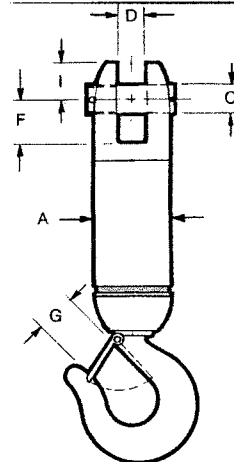

MODEL: 62

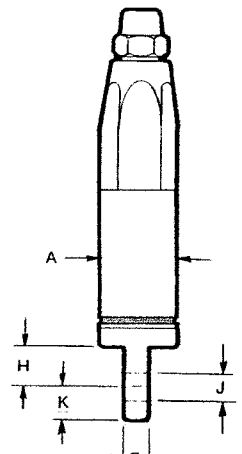

MODEL: 63

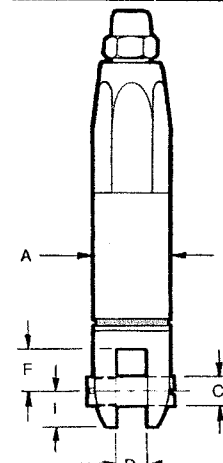

MODEL: 64

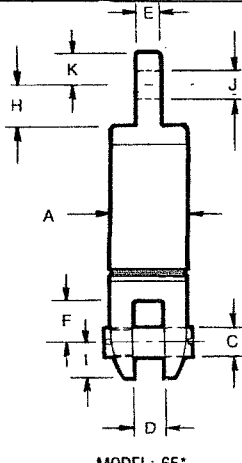

MODEL: 65\*  
\*Model 68 - ends reversed

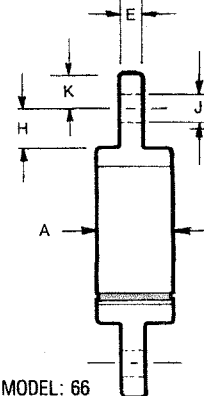

MODEL: 66

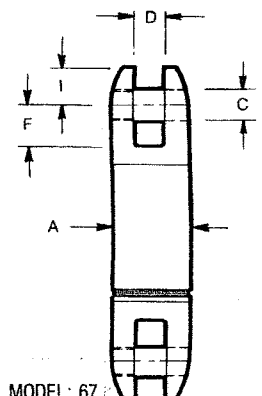

MODEL: 67