

BOLT TYPE ANCHOR SHACKLE

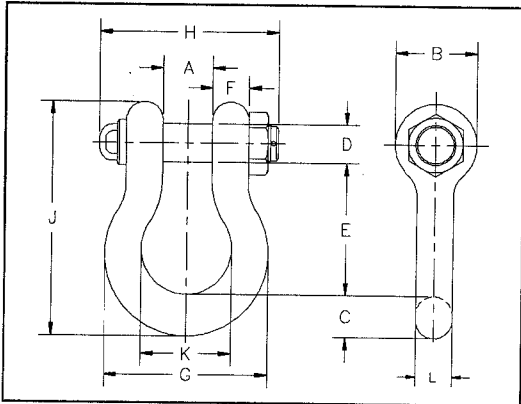

Load Rated



QUIC-CHECK®

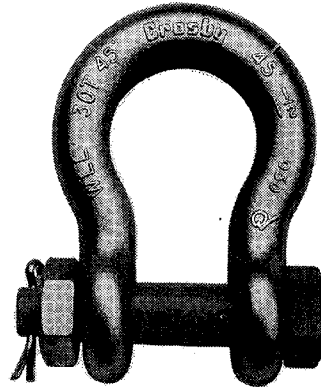

G-2140 and S-2140

G-2140 meets the requirements of Federal Specification RR-C-271D, Type IVA, Grade B, Class 3.

- Working Load Limit is permanently shown on every shackle.
- Alloy bows, Alloy bolts.
- Quenched and Tempered.
- Sizes 200 tons and larger are individually proof tested.
- Forged Alloy Steel 30 thru 175 tons. Cast Alloy Steel 200 thru 600 tons.
- Pins are galvanized and painted orange.

Nominal Shackle Size (in.)	Working Load Limit * (tons)	Stock No.		Weight Each (lbs.)
		G-2140 Galv.	S-2140 S.C.	
1½	30	1021110	1021129	20.8
1¾	40	1021138	1021147	33.9
2	50	1021156	1021165	52.0
2½	80	1021174	1021183	96.0
3	† 110	1021192	—	178.0
3½	† 140	1021218	—	265.0
4	† 175	1021236	—	338.0
4¾**	† 200	1021414	—	—
5 **	† 250	1021432	—	—
6 **	† 300	1021450	—	—
7 **	† 400	1021478	—	—
7½**	†† 500	1021496	—	—
8 **	†† 600	1021511	—	—

Side Loading Reduction Chart For Screw Pin and Bolt Type Shackles Only	
Angle of Side Load from Verticle In-Line of shackle	Adjusted Working Load Limit
0° In-Line *	100% of Rated Working Load Limit
45° from In-Line *	70% of Rated Working Load Limit
90° from In-Line *	50% of Rated Working Load Limit

* In-Line load is applied perpendicular to pin.

Nominal Shackle Size (in.)	Working Load Limit * (tons)	Dimensions (in.)											Tolerance +/-	
		A	B	C	D	E	F	G	H	J	K	L	A	E
1½	30	2.38	3.62	1.62	1.63	5.75	1.39	6.88	7.75	10.00	3.88	1.54	.13	.25
1¾	40	2.88	4.19	2.25	2.00	7.00	1.75	8.86	9.06	12.34	5.00	1.84	.13	.25
2	50	3.25	4.81	2.40	2.25	7.75	2.00	9.97	10.41	13.68	5.75	2.08	.13	.25
2½	80	4.12	5.69	3.12	2.75	10.50	2.62	12.87	13.56	17.84	7.25	2.71	.25	.25
3	† 110	5.00	6.50	3.62	3.25	13.00	3.00	14.36	16.50	21.50	7.88	3.11	.25	.25
3½	† 140	5.25	8.00	4.12	3.75	14.63	3.75	16.50	19.00	24.62	9.00	3.62	.25	.25
4	† 175	5.50	9.00	4.56	4.25	14.50	4.00	18.42	19.75	25.69	10.00	4.10	.25	.25
4¾**	† 200	7.25	10.50	6.00	4.75	15.62	3.75	21.00	20.50	29.25	11.00	4.50	.25	.25
5 **	† 250	8.50	12.00	6.50	5.00	20.00	3.88	24.50	21.97	35.00	13.00	4.50	.25	.25
6 **	† 300	8.38	12.00	6.75	6.00	19.50	4.75	25.00	24.35	35.25	13.00	5.00	.25	.25
7 **	† 400	8.25	14.00	7.25	7.00	22.50	6.50	26.00	27.97	40.25	13.00	6.00	.25	.25
7½**	†† 500	8.31	15.00	7.50	7.50	25.25	6.34	28.00	28.22	44.00	13.00	7.50	.25	.25
8 **	†† 600	9.25	17.00	8.50	8.25	31.88	6.50	31.00	29.97	53.00	14.00	8.50	.25	.25

* Note: Maximum Proof Load is 2.2 times the Working Load Limit. Minimum Ultimate Load is 4 times the Working Load Limit on 200 thru 600 Tons. For sizes 30 thru 175 Tons, Minimum Ultimate Load is 6 times the Working Load Limit.

** Cast Alloy Steel.

† Furnished with Round Head Bolts with welded handle.

†† Maximum Proof Load is 1000 Tons and furnished with Round Head Bolts with welded handle.